

Tool Station
for Parting Off blade

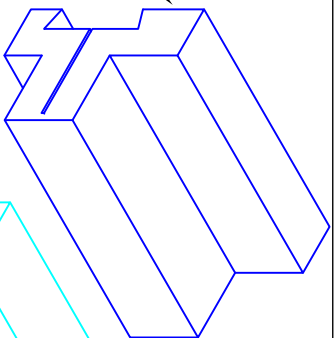

Spacer

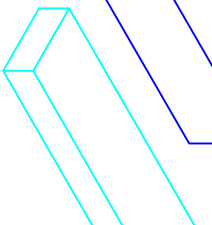

Tool Block for
Parting Off Tool

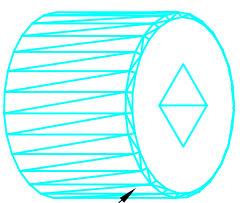
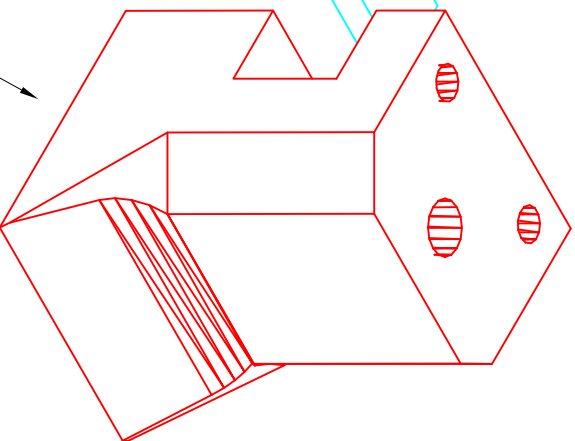

Nut with Socket
for use with
chuck key

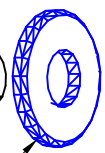

Washer

Tool Post

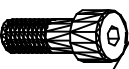

Tool Block for General Tools

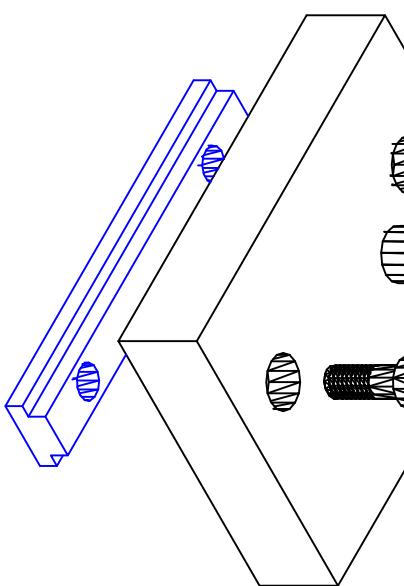

Tool Station
for Square Tools

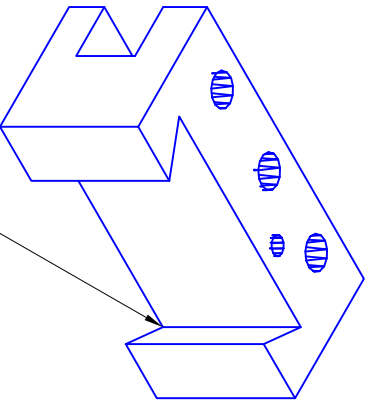

Tool Station
for Boring Tools

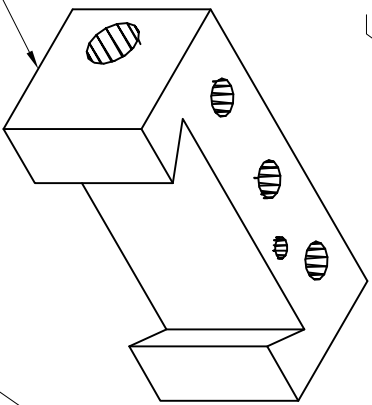

Pressure Plate to hold
Tool Station firm before
height adjustment
(Spring placed in Tool Block
to give pressure)

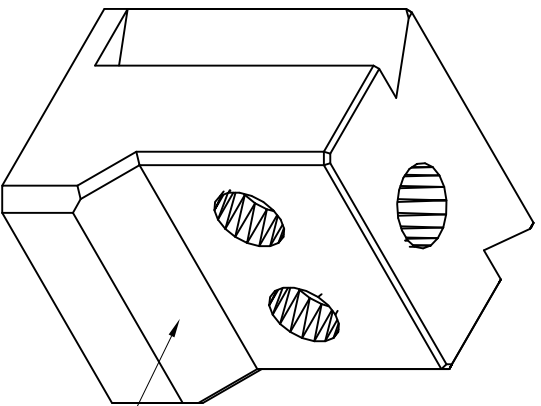
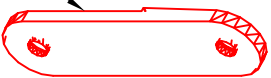

Title:

Workshop - Rear Tool Post GA

Drawing No:

Sheet 7 - 7

Rev:

0

Date:

06-06-07

Scale:

1 : 0.8

Drawn By:

G W Howe